

Section No 278 District Whitemans Valley

Owners & Settlers = THOMPSON - James GORRIE – Charles SWANSON

Buildings =

Subdivisions & Streets = Johnsons Road – TVL Road – Kakariki Road – Hinkley Way

1870-1880

Deeds Index - Map C Hutt District No 279

- No 33988 - Receipt of Instrument 2 pm 20 March 1879 – Nature of Instrument G 189 Conveyance – Date of Instrument 09 February 1874 – Where recorded 56 D/o 437 – Reference Vol 32 folio 233 – Signature Thompson
- No 47424 – Receipt of Instrument 2pm 07 July 1884 – Nature of Instrument Crown Grant – Date of Instrument 04 January 1874 – Where recorded 13 G/o 267 – Reference blank – Signature D1782 W H
- No 47469 – Receipt of Instrument 10.30 am 12 July 1884 – Nature of Instrument Conveyance – Date of Instrument 22 August 1890 [sic] – Where recorded 81 D/. 455 – Reference Vol 34 folio 511 – Charles Swanson

Closed C6463

At bottom of page

33988 Gorrie to Gorrie

47424 Gorrie Jas D1782

47469 Gorrie Jas to Swanson

(Reference Archives NZ Wellington Archway register scanned AFIH 22394 W5691/55 volume 15 Deeds Index – Hutt, Ohariu, Pahautahi Agricultural Reserve, Wainui, Wainuiomata c1844-c1969 Wellington Folio 1 to Folio 557 record online available image 71 Map C Hutt District folio No 179)

2019 Whitemans Valley Rd, Johnsons Rd, Tvl Rd, Kakariki Way & Hinkley Way



(Reference Google Maps Whitemans Valley Road Johnsons Road, Tvl Road, Kakariki Way & Hinkley Way

Section No 279 Whitemans Valley

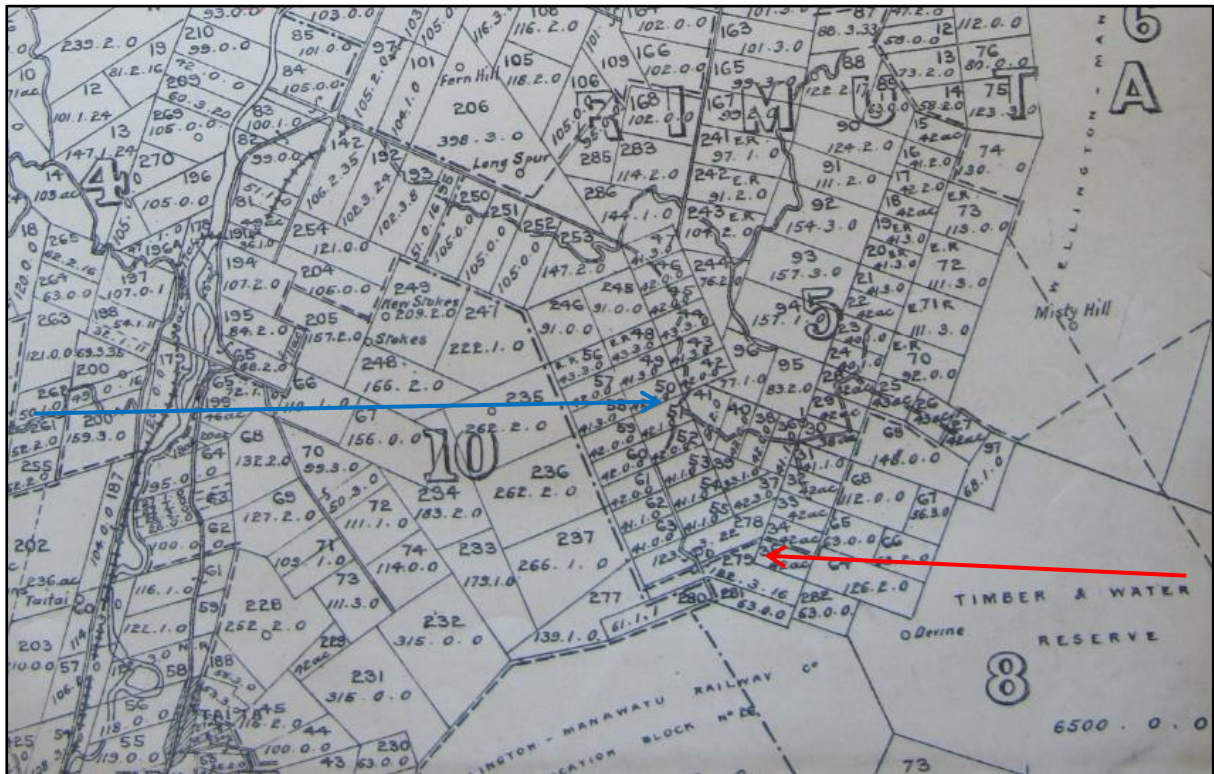

(Reference Archives NZ Wellington maps saved as IMG_1426.jpg)

Section No 279 Whitemans Valley

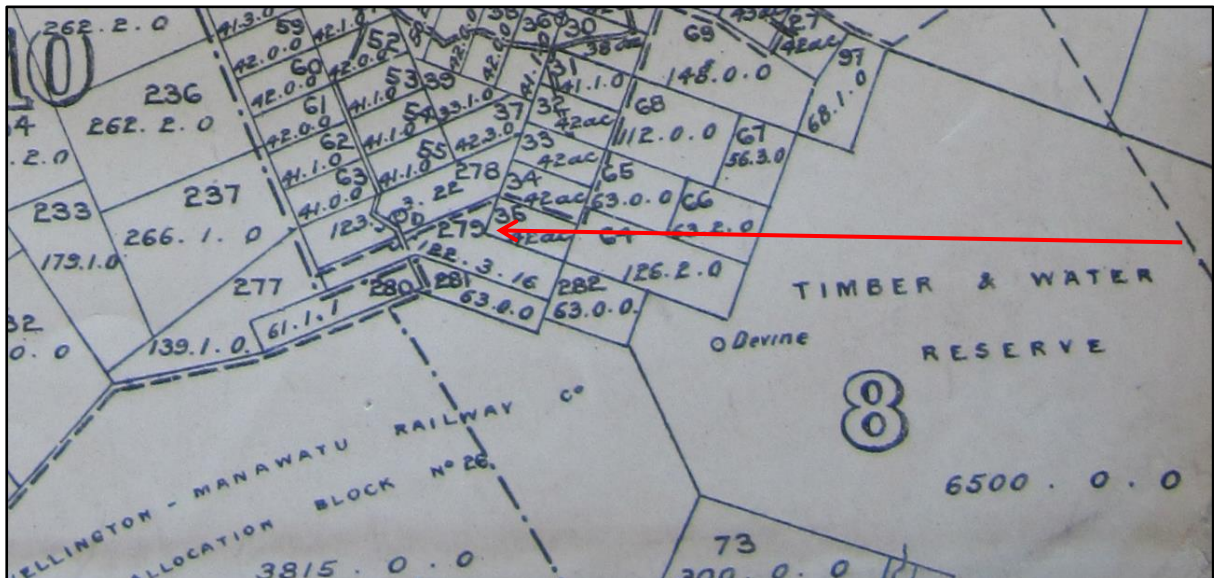

(Reference Archives NZ Wellington maps saved as IMG_1426.jpg)